

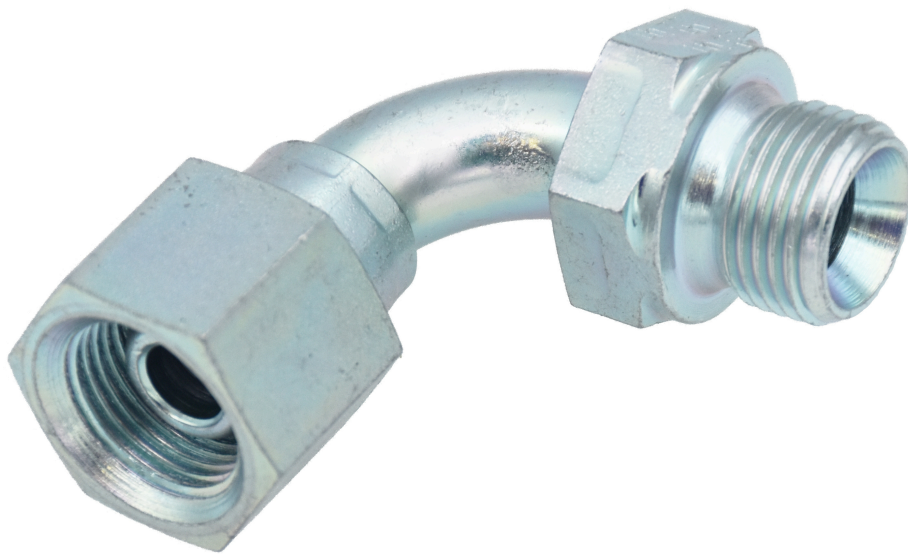

## **ADAPTOR 90° ADJUSTABLE 3/8" (F)-(M) BSP**



Part No  
25102827

## TECHNICAL DATA

### ADAPTOR 90° ADJUSTABLE 3/8" (F)-(M) BSP

Angle-adapters with a swivelling nut, in steel

#### TECHNICAL DATA

Part No	25102827
Thread	3/8" (F)-(M) BSP
Maximum working pressure	64 (640) MPa (bar)
H.S. Code	73079910